

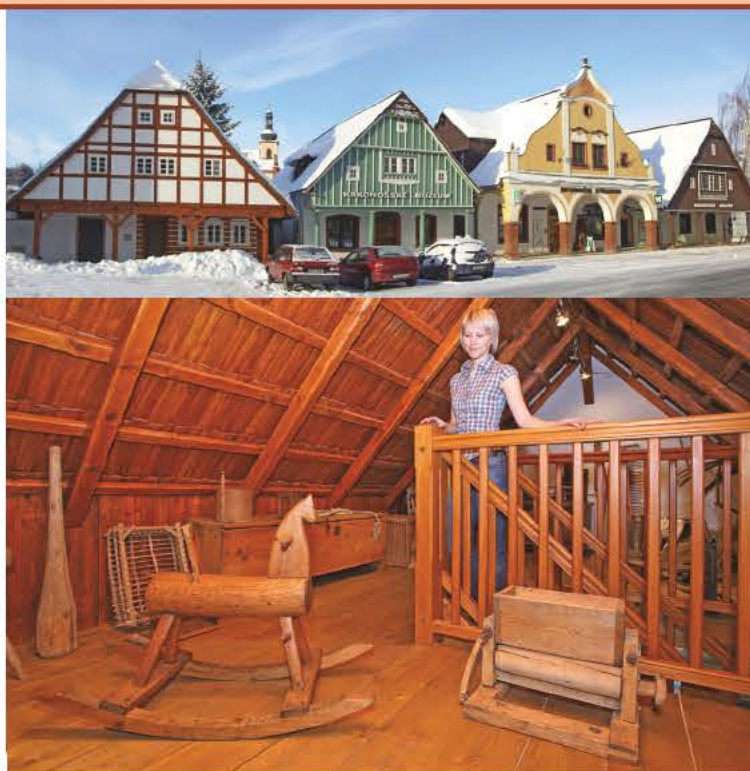

## KRKONOŠE MUSEUM IN VRCHLABÍ – MONASTERY

Husova 213, 543 01 Vrchlabí  
Phone (+420) 499 456 708  
E-mail: [expoze@kmap.cz](mailto:expoze@kmap.cz)  
GPS: 50°37'44.0"N 15°36'19.4"E  
Open daily except Mondays, 8 a.m. to 5 p.m.

- **Stone and Life** – an audiovisual ecological exhibit with specimens of living nature, including a mountain stream with flowing water and terrariums with Krkonoše reptiles and amphibians.
- **Man and Mountains** – an exhibit on the history of settlement in the Krkonoše Mts. from the gradual arrival of man in search of the bounties of the mountains, to the development of metallurgy, glass-making, lodge and forestry management, to scientific understanding and the commencement of tourism.
- Short-term exhibitions.



## KRKONOŠE MUSEUM IN JILEMNICE

Kostelní 75, 514 01 Jilemnice  
Phone (+420) 481 543 041  
E-mail: [kmjilemnice@kmap.cz](mailto:kmjilemnice@kmap.cz)  
GPS: 50°36'37.5"N 15°30'16.0"E  
Open daily except Mondays, 8 a.m. to noon and 1 p.m. to 4 p.m.; between 1/7 and 31/8 opening hours are extended to 5 p.m.

- An exhibit entitled **The Beginnings of Czech Skiing**.
- A historical-ethnographic exhibit of the western Krkonoše Mts. from the 13th century to the present day, with an emphasis on the Harrach noble family, especially Jan Nepomuk Harrach (1828-1909)
- A rich collection of rustic furniture and Krkonoše nativity scenes, including the nativity scene by Jáchym Metelka from 1883-1903 with mechanically produced sound.
- A gallery with works by the prominent Czech landscape painter František Kaván (1866-1941).
- Short-term exhibitions.



## MEMORIAL TO EXILED PATRIOTS IN PASEKY NAD JIZEROU

512 47 Paseky nad Jizerou 121  
Phone (+420) 481 523 609  
E-mail: [muzeumpaseky@kmap.cz](mailto:muzeumpaseky@kmap.cz)  
GPS: 50°43'26.7"N 15°24'02.2"E  
Open January, April, October, December: Tue-Sat 9 a.m. to noon and 1 p.m. to 4 p.m. February-March, May-September: Tue-Sun 9 a.m. to noon and 1 p.m. to 4 p.m. November closed!

- **Krkonoše Violin-Making School** – an exhibition with a unique collection of musical instruments showing Paseky nad Jizerou as a cradle of violin-making and Věnceslav Metelka as its founder.
- A cultural-historic and ethnographic exhibition, including examples of traditional products – a woodturning workshop with a wooden treadle lathe and functional manual looms.
- Short-term exhibitions.

## Krkonoše Museums – the region's memory

The Krkonoše National Park Administration operates a network of Krkonoše Museums in Vrchlabí, Jilemnice, Paseky nad Jizerou and Harrachov. The mission of these facilities is to document the uniqueness of the local mountain region and to preserve evidence for future generations. Permanent exhibits and special exhibitions introduce visitors to the natural, historic and cultural heritage of the Krkonoše Mts.



## KRKONOŠE MUSEUM IN VRCHLABÍ – FOUR HISTORIC HOUSES

nám. Míru 222–224, 543 01 Vrchlabí  
Phone (+420) 499 456 761, (+420) 499 421 474  
E-mail: [his@kmap.cz](mailto:his@kmap.cz)  
GPS: 50°37'46.2"N, 15°36'26.4"E  
Open daily except Mondays, 9 a.m. to noon and 1 p.m. to 4 p.m.; between 1/6 and 30/9 opening hours are extended to 5 p.m.

- An ethnographic exhibit entitled **The Works of Krkonoše People**; a rustic interior with loom from the last Krkonoše weaver, Matěj Pochop.
- The **History of Vrchlabí** and Artistic Crafts exhibits.
- A depository open to the public with examples of traditional woodworking and textile goods.
- Short-term exhibitions. kurzfristige Ausstellungen



## HARRACHOV "ŠINDELKA"

512 46 Harrachov 269  
Phone (+420) 481 528 310  
E-mail: [sindelka@kmap.cz](mailto:sindelka@kmap.cz)  
GPS: 50°46'11.5"N 15°26'14.7"E  
Open daily except Mondays, 9 a.m. to noon and 1 p.m. to 5 p.m.

- A forestry and wood processing exhibit with a working model of log floating.
- A hunting exhibit with a winter game preserve, illustrations of hunting traditions, game, weapons and dogs.
- Shingle-manufacturing show.



Published by The Krkonoše National Park Administration in 2014.  
Photo: © Kamila Antošová, © Radek Drahný  
Graphics: © 2123design s.r.o.  
Printed on recycled paper.

ISBN: 978-80-87706-54-1





### Regular information centres (IC):

#### IC Vrchlabí

Náměstí Míru 223,  
543 01 Vrchlabí  
Phone (+420) 499 456 761,  
(+420) 499 421 474  
hic@knap.cz  
GPS: 50°37'46.6"N  
15°36'26.0"E

#### IC Harrachov

512 46 Harrachov 442  
Phone (+420) 481 529 188  
icharrachov@knap.cz  
GPS: 50°46'13.9"N  
15°26'02.6"E

#### IC Špindlerův Mlýn

543 51 Špindlerův Mlýn 269  
Phone (+420) 499 433 228  
icspindl@knap.cz  
GPS: 50°44'09.3"N  
15°36'29.7"E

#### IC Pec pod Sněžkou

542 21 Pec pod Sněžkou 172  
Phone (+420) 499 896 213  
icpec@knap.cz  
GPS: 50°41'36.3"N  
15°43'58.8"E

#### Memorial to Fallen Patriots

512 47 Paseky nad  
Jizerou 121  
Phone (+420) 481 523 609  
muzeumpaseky@knap.cz  
Open January, April, October,  
December: Tue-Sat 9-12,  
13-16. February-March, May-  
September: Tue-Sun 9-12,  
13-16. November closed!  
GPS: 50°43'26.7"N  
15°24'02.2"E



### Seasonal information centres:

Zlaté návrší Cabin

Labský důl Cabin

### Seasonal information centres offer:

- information on the Krkonoše National Park and the Krkonoše Mts.;
- the sale of maps, guidebooks, postcards, souvenirs and promotional materials;
- suggestions for hiking and bike trails, tourist stamps.

### OPENING HOURS

1/6-30/9 Mon-Sun 9:00-17:00

#### Zlaté návrší Cabin

GPS: 50°45'06.6"N 15°32'58.3"E

#### Labský důl Cabin

GPS: 50°44'27.631"N 15°36'18.212"E

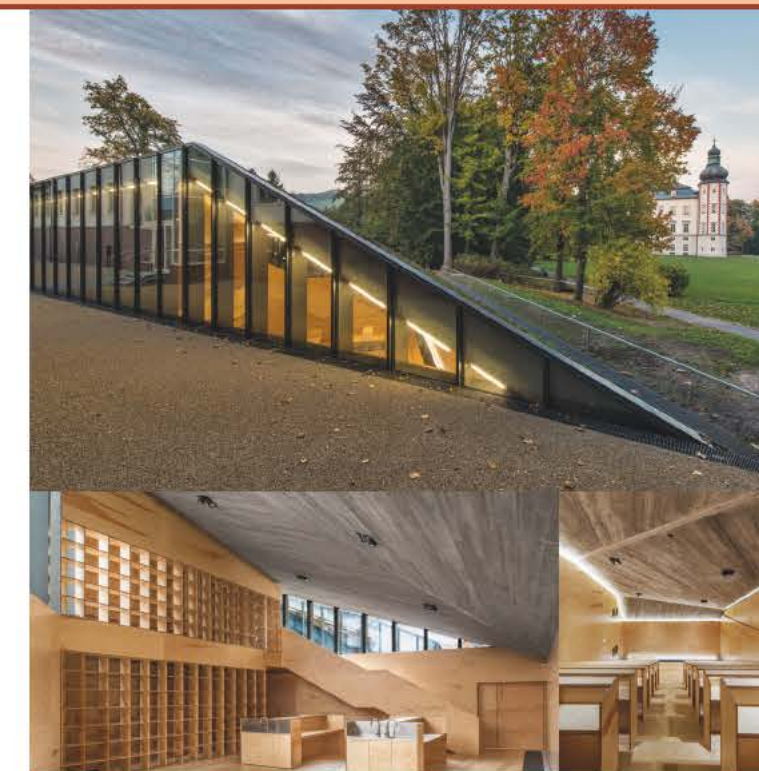

## KRKONOŠE MUSEUMS AND NATIONAL PARK INFORMATION CENTRES

### Krkonoše Environmental Education Centre - Krtek

The Krkonoše Environmental Education Centre - K RTEK is expanding its offer of educational activities for the general public. This is the place to hold public lectures and conferences. The centre contains a lecture theatre with a capacity of 76 places + 2 wheelchair accessible places for disabled visitors. Thanks to the use of a wide screen and surround sound it has the parameters of a small cinema. A laboratory and a classroom may also be used for lessons. The direct contact between the theoretical and practical teaching plays an important role in the education. Therefore the laboratory is an integral part of the centre. The laboratory has a capacity of 16 students and the classroom accommodates 30 students. The building also contains an exhibition space, library, ecological advice centre and parking spaces for clients.

Free tours are available every Tuesday from 3 PM to 5 PM, and at other times other times by appointment.

We offer special programmes for all levels of schools.

Phone (+420) 499 456 119, [krtek@knap.cz](mailto:krtek@knap.cz), [www.knap.cz](http://www.knap.cz)



## Krkonoše National Park Information Centres

The Krkonoše National Park Information Centres offer visitors to the Krkonoše Mts. comprehensive information regarding the national park, including trips to points of interest, scenic areas and tourism sights in the country's highest mountain range. Each information centre features a small exhibition highlighting interesting facts about the nature and history of the Krkonoše Mts., including a number of games for children. We also offer opportunities to screen films with an ecological theme and to host lectures. School groups can arrange to be accompanied by a Krkonoše National Park ranger, who will provide information on the relevant location directly in the field.

### Regular information centres:

Vrchlabí  
Harrachov  
Špindlerův Mlýn

Pec pod Sněžkou  
Paseky nad Jizerou



### Regular information centres offer:

- information on the Krkonoše National Park and the Krkonoše Mts.;
- exhibitions on the nature and history of the Krkonoše Mts.;
- the sale of maps, guidebooks, postcards, souvenirs and promotional materials;
- the screening of video programs on the Krkonoše Mts. and nature for children and adults;
- booking of lectures and presentations (including those outside the information centre), in the field;
- the issuance of vehicle entry permission (including the payment of fees) for the Krkonoše National Park.

### INFORMATION CENTRE OPENING HOURS\*

1/6-30/9	Mon-Sun	8.30-12.00	12.30-17.00
1/10-26/12	Mon-Fri	8.00-12.00	12.30-15.00
27/12-31/3	Mon-Fri	8.30-12.00	12.30-17.00
1/4-31/5	Mon-Fri	8.00-12.00	12.30-15.00

\*) Does not apply to information center Paseky nad Jizerou

Actual opening hours on the [www.knap.cz](http://www.knap.cz)

